



## **2023 STATE PACKET**

58<sup>TH</sup> Wisconsin State 4-H Horse Expo

Wisconsin State Fair Park

September 15-17, 2023



## **58<sup>th</sup> WISCONSIN STATE 4-H HORSE EXPO**

September 15-17, 2023

### **RULES & CLASS LIST**

“Welcome to the Wisconsin State Fair Park”  
Milwaukee/West Allis, WI



**MISSION STATEMENT** of the Wisconsin 4-H Horse Association, Inc

**To provide lifetime skills and learning experiences for the 4-H Horse and Horseless horse project members, their families and their leaders.**

### **RELEASE STATEMENT**

1. By participating, entrants agree to the official rules and decisions of the judges and/or show committee, which will be final in all respects.
2. According to WI Statue 895.525: A participant in a recreational activity accepts the risk inherent in the recreational activity of which the ordinary prudent person is or should be aware.
3. Any questions arising that are not covered in the rules will be decided by the judges and/or the show committee.

### **DISCIPLINE/PROTEST PROCEDURE**

1. If you observe a rule being broken, please make the exhibitor and/or spectator aware of the rules and report any further problems/incidents to a director or show official. If you feel further action is necessary, come to the office and complete a written grievance form. The protest or charge must be signed by the person(s) observing the incident and contain a clear and definite statement of the violation. The chairman of the grievance committee will begin any necessary action as soon as possible. If a hearing is necessary, those attending the hearing are limited to the members of the grievance committee, person(s) filing the complaint, those involved in the incident, family members, and any appropriate witnesses.
2. Depending on the complaint, the grievance committee will take appropriate action, up to and including expulsion from the Expo.
3. The decision of the grievance committee is final.wiwi
4. If disciplinary action is taken, a follow-up letter will be sent to the County Extension Agent. A copy of the letter may be sent to the parent(s)/guardian(s) of the exhibitor.

### **EXPECTATION STATEMENT OF EXHIBITORS**

1. You are intelligent, responsible, and sufficiently mature to conduct yourselves in an appropriate manner at all times. You are expected to respect the rights of others.
2. You are not to leave the State Fair Park without consulting the adult (parent/guardian/leader) in charge of your county delegation.
3. You are to maintain sleeping and quiet hours as designated, this includes campers and those in motels. No overnight in tack or horse stalls.
4. You are to refrain from smoking and/or using alcoholic beverages and other drugs. The only exceptions are aspirin or similar products.
5. It is a privilege to participate in the Wisconsin 4-H Horse Expo. This privilege can be revoked and the exhibitor will be returned home at the parent(s)/guardian(s) expense.
6. **ALL HELMETS MUST BE SEI APPROVED. SEI APPROVED HELMETS WITH CHIN STRAP FASTENED MUST BE WORN BY ALL EXHIBITORS WHEN MOUNTED OR DRIVING DURING STATE 4-H HORSE EXPO.**

## GENERAL RULES AT EXPO

1. Exhibitor number must be worn and visible at all times when on the show grounds of the State Fair Park. **(See Equestrian Guidelines for requirements while showing.)**
2. No mopeds, three or four wheel ATV vehicles will be permitted, except for official use.
3. No radios, refrigerators, space heaters **OR ANY TYPE OF COOKING APPLIANCE** allowed in the barns.
4. No roller blades allowed. Bicycles and skateboards are restricted to areas where there are no horses.
5. One fan, no larger than 24" in diameter, is permitted per animal
6. Dogs must be leashed and remain in camping areas.
7. No alcoholic beverages or illegal drugs allowed on the show grounds. Adults, as well as exhibitors, are expected to follow this rule.
8. No smoking in buildings. Please help us comply with State Fair Park regulations.
9. Any NSF checks or stop payment checks will result in the family being restricted from any state activity until the check(s) and all incurred expenses have been settled.
10. For safety purposes a halter and lead must be left on all occupied horse stalls.

## CAMPING INFORMATION

1. Overnight RV camping is available at Wisconsin State Fair Park (see RV Park Info)  
NO TENT camping. (If you are staying overnight in your vehicle you will be charged a camping fee.)
2. Showers available 24 hours a day (in east end of 2 story barn).
3. Parking in DESIGNATED areas at State Fair Park. (Vehicles blocking fire lanes will be ticketed and/or towed.)
4. Horse trailers may park free in an area designated by show facility. Any trailer on the show grounds MUST purchase a 4-H trailer permit and display on vehicle in designated parking areas during Expo.

## HOUSING

- Dorms will be available - see registration form.

## FOOD

The concession stands will be open throughout the day. They are operated independently. The Wisconsin 4-H Horse Association, Inc. has no control over and obtains no income from these concession stands.

## TELEPHONE NUMBERS

Phone numbers for local veterinarians and farriers will be available in the Show Office.

## SHOW PHOTOGRAPHER

Ryan Geiger Photography

[RyanGeigerPhotography@gmail.com](mailto:RyanGeigerPhotography@gmail.com)

[www.RG.Photography](http://www.RG.Photography)

614-419-3400

## SHOW MANAGEMENT

**President**

Dale Bauer (715) 672-5782

**Vice-President**

Gail Johnson (262) 206-4005

**Secretary**

Katie Stenroos (218) 269-5733

**Treasurer**

Sherry Helmer (920) 928-2478

**Executive Secretary**

Linda Pribek (920) 839-5540

## SPONSORSHIPS

Since entry fees do not begin to cover the expenses of the Expo, each county is expected to provide at least one sponsorship (trophy or ribbons for the horse show, or an educational event) per ten exhibitors (total of horse show and educational exhibitors). If fewer than ten, one sponsorship is still expected. If 11-20, two sponsorships are expected and so on. **(NOTE: Small counties with a TOTAL of LESS Than five (5) exhibitors at ALL THREE state shows combined will be required to submit one-half sponsorship PER SHOW.)** Forms can be obtained on the State Website. Please provide sponsorship money with an entry packet from the county.

Your help in this area will be greatly appreciated.

# **EDUCATIONAL CONTESTS**

## **General Rules**

1. Eligibility - Any member currently enrolled in the 4-H Horse & Pony or the Horseless Horse project may participate. They do not have to be exhibiting a horse/pony at the horse show. Participants must be in at least third grade
2. All exhibits are to be the work of the exhibitor and related to the Horse and Pony or Horseless Horse Projects in the current year.
3. Entries must be signed by the University Extension Agent, parent(s)/guardian(s), and exhibitor and submitted as a county.
4. Entries must be postmarked by August 1st.
5. All contests must be pre-entered. No entry changes made at show.
6. No refunds on educational entries.
7. Attach checks to entry form and make them payable to the WI 4-H Horse Association
8. Grade is determined as of the school year of current 4-H enrollment.
9. **All team entries MUST be comprised of 4-H youth enrolled within the same county.**
10. After arriving on State Fair Park grounds, pick up exhibitor number and sign in at the Show Office.
11. Wisconsin 4-H Horse Association is NOT responsible for any lost, stolen, or damaged items.
12. A Grand, Reserve and eight top ten ribbons will be awarded. Disqualified entries are NOT eligible for awards but will be critiqued by the judge with reason for disqualification written on judge's form.
13. Only 1 entry per category is permitted (exhibitor may not show against himself). If more than 1 entry is made in a category the chairperson will randomly select 1 entry to be judged and the other one(s) will be disqualified.

## **New for 2023**

- Woodworking has been moved to the Art Division under Any Other Art and Craft
- Poster, Creative Writing, and Vet Science have been moved into a new category called Creative Communications

## **Art Contest (Awards in memory of Troy Landwehr)**

**See Committee List for Chairman**

1. **Day/Time:** See show schedule for date and time
2. **Entry Fee:** \$6.00 per entry.
3. **Grade Divisions:** Junior 3 - 8  
Senior 9 -13
4. For complete rules regarding this contest please refer to Educational Events in the 4-H Horse Handbook.

## **Creative Communication See Committee List for Chairman**

1. **Day/Time:** See show schedule for date and time
2. **Entry Fee:** \$6.00/person. (Team entry fee includes individual entry.)
3. **Grade Divisions:** Junior 3 - 8  
Senior 9 - 13
4. For complete rules regarding this contest please refer to Educational Events in the 4-H Horse Handbook.
5. Exhibitor is limited to one entry per category.

## **Judging Contest**

**See Committee List for Chairman**

1. **Day/Time:** See show schedule for date and time
4. **Entry Fee:** \$6.00/person. (Team entry fee includes individual entry.)
5. **Grade Divisions:** Junior 3 - 8  
Senior 9 - 13
4. For complete rules regarding this contest please refer to Educational Events in the 4-H Horse Handbook.

## **Model Horse Show**

**See Committee List for Chairman**

1. **Day/Time:** See show schedule for date and time
2. **Entry Fee:** \$3.00 per entry per class plus \$10.00 stable fee per exhibitor.
3. For **class list, rules, and general information**, see Model Horse Show Rules and Class List in 4-H Horse Handbook.

## **Photography Contest**

**See Committee List for Chairman**

1. **Day/Time:** See show schedule for date and time
2. **Entry Fee:** \$6.00 per entry
3. **Grade Divisions:**

Junior	3 - 8
Senior	9 - 13
4. For complete rules regarding this contest please refer to Educational Events in the 4-H Horse Handbook.

## **Team Problems**

**See Committee List for Chairman**

1. **Day/Time:** See show schedule for date and time
2. **Entry Fee:** \$6.00 per **exhibitor**
3. **Grade Divisions:**

Junior	3 - 8
Senior	9 - 13
4. Team consists of 2 to 4 individuals.
5. For complete rules regarding this contest please refer to Educational Events in the 4-H Horse Handbook.

# HORSE SHOW

## General Information

1. All exhibitors are expected to bring their own feed and equipment and to keep their stalls, as well as their trailer area, clean. Exhibitors are responsible for the care of their equipment and animal at all times. No bedding provided with the stall. Exhibitors are **required** to clean stalls before leaving. A \$50.00 penalty fee per stall will be billed to any county that fails to comply.
2. Shavings will be sold on the grounds.
3. Awards: A Grand, Reserve and eight Top Ten awards will be awarded in each class. Disqualified entries are NOT eligible for awards.
4. All classes will be judged according to the Wisconsin 4-H Horse Association Equestrian Guidelines.
5. The Show Committee reserves the right to cancel or combine classes with insufficient entries (three or less).

## General Rules for State 4-H Horse Expo

1. Exhibiting in the State 4-H Horse Show is open to any eligible 4-H Horse Project member in grades 6 through 13, who has been approved by a University Extension Educator in their county. They must be a 4-H member in good standing.
2. Donkeys and Mules are not allowed
3. An exhibitor may enter a maximum of 8 horse classes.
4. State Expo is an opportunity for our YOUTH to exhibit the skills they have learned during the current project year. To promote this goal, no professional grooms or trainers (persons being paid for grooming, training and/or lessons) are permitted to work with youth or horses in a professional (paid) capacity on Expo grounds.
5. No grooms or trainers are to be in the ring or on the rail during the show (except headers in the driving classes). No coaching from the rail or viewing area.
6. **Horses cannot be ridden, driven or schooled by anyone other than the exhibitor.**
7. **You may only be mounted in designated areas. Horses must be appropriately tacked (saddle and bridle). We do not permit bareback riding. Rider must be appropriately attired (boots, helmet and exhibitor # visible) when riding on horse show grounds. NO RIDING DOUBLE.**
8. **SEI approved helmet with safety harness securely fastened is required when riding or driving at State Expo.**
9. Horses must be mounted and dismounted outside. No riding in the barn.
10. **Lunging of horses is to be done ONLY in the designated lunging areas.**
11. Special permission for lunging another exhibitor's horse for hardship cases ONLY may be obtained by reporting circumstances to the office. Special permit MUST BE WORN while handling animal.
12. Working or exercising your horse is limited to the practice area.
13. Any person handling/leading a horse must wear proper footwear – NO open toed footwear allowed.
14. Horses may be brought into the State Fair Park Thursday, **after Noon**. Horses must be kept in stalls until 3:00 pm Thursday. Coliseum and practice areas will NOT be open until 3:00 PM. Grounds must be vacated by 7:00 PM on Sunday. **(Counties will be charged \$50 per stall if a stall is not cleaned out before leaving.)**
15. A contestant may approach the judge, in the presence of a director or ring steward, only **AFTER** the exhibitors' classes under that judge have been completed.

## Eligibility of the Horse

1. The horse/pony must be carried as a 4-H Horse/Horseless Horse project.
2. The horse may be either owned, leased or managerial. A managerial animal is a horse that is under the care of, but not owned by, the exhibitor.
3. If the horse you entered becomes injured or lame (verified by vet excuse) you may replace that horse with another 4-H horse/horseless horse project animal.

## General Horse Rules for Horse Show

1. No stallion may be shown.
2. An exhibitor is allowed to show only one horse/pony at the State Expo. Horseless Horse may only enter Horseless Horse Showmanship, walk/trot equitation, walk/trot pleasure, and In-Hand trail.
3. Copy of Negative EIA/Coggins, in compliance with Wisconsin law, *must be stapled to entry form. (Original must be brought with horse to Expo and shown to check-in personnel.)*
4. The animal must be in a good state of health and not showing evidence of any contagious or infectious disease. Horses found to be infected with contagious disease will be ordered to be removed from the State Expo.
5. Ponies may enter only classes designated as a pony class. **(NOTE: Once you have entered a pony division you must remain in the pony division for the entire show.)** Ponies include heights of 56" and under. Any horse over 56" must enter horse classes. **All ponies entered in a pony class must be measured before exhibitor number is issued.**
6. Miniatures: We recognize that miniatures are a horse breed, but for safety reasons they must enter pony classes in this show.
7. Only members of the same family, and a 4-H youth paired with a Horseless Horse youth, are permitted to show the same project animal. Each family member may show any combination of classes provided the horse is only shown once in a specific class number.
8. Any non-therapeutic substance used as a stimulant, depressant, tranquilizer or sedative for the purpose of altering a horse or ponies show ring performance is prohibited. Failure to comply will result in disqualification.
9. A junior (5 years or under) horse/pony shown with a snaffle bit (no shanks) or bosal must be ridden with both hands on reins. They may enter the appropriate stock seat, western pleasure, western riding and/or trail class.

## Horse Show Entry Requirements/Procedures

1. Entries must be postmarked by August 1st. **LATE ENTRIES WILL BE REJECTED AND RETURNED.**
2. Entries *must* be sent to the Executive Secretary in **ONE** envelope per county. Correct fees must be attached to each entry (a county check must be itemized). Entries received any other way will be returned.
3. Entries must be signed by the University Extension Educator, Parent/Guardian (must be signed for the 18 & 19 year-old youth also) and the Exhibitor.
4. All classes must be pre-entered. No entry changes unless horse/pony measurement requires change OR a veterinary replacement for lame or injured horse (see eligibility #5)..
5. Entry fees are \$10.00 per class.
6. Stall fee is \$40.00 per box stall. A stall will be required for each horse. Horses **MAY NOT** be tied to trailers or other areas on show grounds.
7. Tack stall fee is \$40.00. No sleeping overnight in tack or horse stalls.
8. Tack trailer permits may be purchased at Expo for a \$40.00 fee.



## How to Enter the Horse Show

1. Read all rules thoroughly.
2. You must be a currently enrolled WI 4-H Horse/Horseless Horse Project Member.
3. Participation in Expo events require pre-entry on forms provided. Every participant will be issued a number.
4. Read entry blanks carefully.
5. Horseless horse exhibitors may only show in horseless horse classes.

## Refunds for Horse Show

1. No refunds on class fees will be made because an animal cannot come to the State Expo unless it is accompanied by an official veterinarian's certificate. Requests for refunds will not be considered unless notification is received PRIOR TO Expo and documents are postmarked within one week of Expo.
2. Exhibitors supplying a doctor's excuse for not attending will be eligible for refunds of class fees. Notification must be received PRIOR TO Expo and documents must be postmarked within one week of Expo.
3. The stall fee is used for administration and will not be refunded.

## Trail Class

1. Must be pre-entered on entry sheets in designated space.
2. The class will be judged with a score sheet.
3. The trail class will be run concurrent with the other show schedule. Trail pattern posted on State 4-H website.
4. The course will be set up with pattern posted one (1) hour before the start of the first rider. Practice on course will not be allowed, but contestants may walk through the course on foot. **No horses allowed on or near course unless being judged.**
5. Numbers will be taken of horses waiting in line before close of trail. Riders not present will NOT be allowed to run. See show schedule for dates and times.

\*It is not the intention of this association to provide an unfair advantage to any youth/exhibitor. Therefore, no designated practice area duplicating two or more parts of the trail class may be set up on the show grounds.\*

## Barn Awards

1. Counties that wish to enter must indicate on the 4-H Horse Expo County Entry Form.
2. Cleanliness and neatness of the stalls, aisles and exhibitors is expected. For safety, stall gates must be securely tied at night. Unsafe conditions or behavior may cause your county to lose points in one or more areas on the evaluation sheet.
3. Barn/stall decorations are permitted, as approved by Fire Marshall and State Fair Park.
4. Awards: Grand and Reserve in each division will be presented in small, medium, and large divisions.

# 58<sup>th</sup> WISCONSIN STATE 4-H HORSE EXPO 2023 SHOW SCHEDULE

Previous class will be dismissed BEFORE the next class enters the ring.

LUNGING PERMITTED IN COLISEUM from 5:00 AM – 6:00 AM ONLY. Driving Practice from 6:15 – 6:45 AM.

Lights will be turned off in the barns at 11:00 PM or ½ hour after show IF classes run past 10:30 PM.

## Friday, September 15, 2023

Creative Communications, Art, and Photography Exhibits must be in the Education Area by 9:00 AM on Friday. (exhibits can be dropped off Thursday from 1pm - 8pm in the education area)

### EDUCATION JUDGING TIMES

Art 10:00 AM-12:00 NOON **Face-to-face judging**

Creative Communications and Photography 10:00 AM **Non-face-to-face judging will continue until all entries are judged and placed.**

**Educational Awards presentation for art, creative communications, and photography is in the Education Area on Friday – announcement will be made when awards are ready to pick up**

**Trail Class 10:00 AM - 7:00 PM**

**Flag Ceremony 7:50 AM**

**Two (2) Minute Gate Rule**

**Horse Show – Coliseum 8:00AM**

1. Draft Type Showmanship, Horse/Pony, 6-13
2. Cones - Driving Horse/Light, Draft, and Pony, 6-13
3. Pleasure Driving - Horse/Light, Draft, and Pony, 6-13
4. Reinsmanship - Driving Horse/Light, Draft, and Pony, 6-13

\* Driving Classes 3 and 4 will be judged and placed as one class (pony, light and draft together). The judge has the option to create class cuts in pleasure and reinsmanship based on size or discipline during the judging process and bring all entries back for final placings.\*

**Horse Show – Coliseum 10:30 AM**

5. Horseless Horse Walk/Trot Pleasure, Grades 6-13
6. Horseless Horse Walk/Trot Eq/Horsemanship, Grades 6-13
7. Saddle Seat Pleasure, Grade 6-13
8. Saddle Seat Equitation, Grade 6-13
9. Pony Saddle Seat/Hunt Pleasure, Grades 6-13
10. Pony Saddle Seat/Hunt Equitation, Grades 6-13
11. Hunter Under Saddle, Grade 6
12. Hunt Seat Equitation, Grade 6
13. Hunt Under Saddle, Grade 7
14. Hunt Seat Equitation, Grade 7
15. Hunter Under Saddle, Grade 8
16. Hunt Seat Equitation, Grade 8
17. Hunter Under Saddle, Grade 9
18. Hunt Seat Equitation, Grade 9

**Horse Show – Coliseum 5:30**

**Judging Contest**

LUNGING PERMITTED IN COLISEUM from 5:00 AM - 6:15 AM ONLY.

Lights will be turned off in the barns at 11:00PM or ½ hour after show IF classes run past 10:30 PM.

**Saturday, September 16, 2023**

**Team Problems 11:00 AM – 3:00 PM in Education Area**

**Trail Class 10:00 AM – 5:30 PM**

**Judging & Hippology Awards 9:00 AM**

**Presented in Education Area**

**Model Horse 10:00 AM in Education Area**

Two (2) Minute Gate Rule

**Horse Show – Coliseum – Ring 1 7:00 AM**

**Flag Ceremony 6:50 AM**

19. Pony Western Showmanship, Grades 6-13
20. Western Showmanship, Grades 12-13
21. Western Showmanship, Grade 11
22. Western Showmanship, Grade 10
23. Western Showmanship, Grade 9
24. Western Showmanship, Grade 8
25. Western Showmanship, Grade 7
26. Western Showmanship, Grade 6

**Horse Show – Coliseum – Ring 2 7:00 AM**

27. Hunt Showmanship, Grade 9
28. Hunt Showmanship, Grade 8
29. Hunt Showmanship, Grade 7
30. Hunt Showmanship, Grade 6
31. Saddle Seat Showmanship, Grade 6-13
32. Horseless Horse Showmanship, Grades 6-13
33. Pony Hunt/Saddle Seat Showman, Grade 6-13
34. Hunt Showmanship, Grade 11
35. Hunt Showmanship, Grades 12-13
36. Hunt Showmanship, Grade 10

**Horse Show – Coliseum – 12:30 PM**

37. Western Riding, Grades 6-7
38. Western Riding, Grades 8-9
39. Western Riding, Grades 10-11
40. Western Riding, Grades 12-13

**Horse Show – Coliseum – 4:00 PM**

41. Hunter Under Saddle, Grade 10
42. Hunt Seat Equitation, Grade 10
43. Hunter Under Saddle, Grade 11
44. Hunt Seat Equitation, Grade 11
45. Hunter Under Saddle, Grades 12-13
46. Hunt Seat Equitation, Grades 12-13

LUNGING PERMITTED IN COLISEUM from 5:00 AM - 6:15 AM ONLY.

**Sunday, September 17, 2023**

Two (2) Minute Gate Rule

**Horse Show – Coliseum 7:00 AM Flag Ceremony 6:50 AM**

47. Pony Western Pleasure, Grades 6-13
48. Pony Stock Seat Equitation, 6-13
49. Western Pleasure, Grade 6
50. Stock Seat Equitation, Grade 6
51. Western Pleasure, Grade 7
52. Stock Seat Equitation, Grade 7
53. Western Pleasure, Grade 8
54. Stock Seat Equitation, Grade 8
55. Western Pleasure, Grades 12-13
56. Stock Seat Equitation, Grades 12-13
57. Western Pleasure, Grade 11
58. Stock Seat Equitation, Grade 11
59. Western Pleasure, Grade 9
60. Stock Seat Equitation, Grade 9
61. Western Pleasure, Grade 10
62. Stock Seat Equitation, Grade 10

**Trail, Team Problems & Barn Awards 10:00 AM  
presented in Trail Arena**

**Trail – Friday (10:00am - 7:00pm) & Saturday (10:00am - 5:30pm)**

Exhibitors may walk course a ½ hour before the course opens

Numbers will be taken of horses waiting before closing time. Riders not present will NOT be allowed to run.

63. Trail, Grade 6
64. Trail, Grade 7
65. Trail, Grade 8
66. Trail, Grade 9
67. Trail, Grade 10
68. Trail, Grade 11
69. Trail, Grades 12 - 13
70. In Hand Trail, Grade 6
71. In Hand Trail, Grade 7
72. In Hand Trail, Grade 8
73. In Hand Trail, Grade 9
74. In Hand Trail, Grade 10
75. In Hand Trail, Grade 11
76. In Hand Trail, Grade 12-13
77. Horseless Horse In Hand Trail, Grades 6-13



UW-MADISON EXTENSION

An EEO/AA employer, University of Wisconsin-Extension provides equal opportunities in employment and programming, including Title IX and American with Disabilities (ADA) requirements. © 2004 by the Board of Regents of the University of Wisconsin System. Developed by the Wisconsin 4-H Office, 130 Pyle Center, 702 Langdon St., Madison, WI 53706. The 4-H name and emblem are federally protected under Title 18 US Code 707.

*Please make requests for reasonable accommodations to ensure equal access to the event before the registration deadline.*

# Wisconsin State Fair Park

## Milwaukee/West Allis, Wisconsin

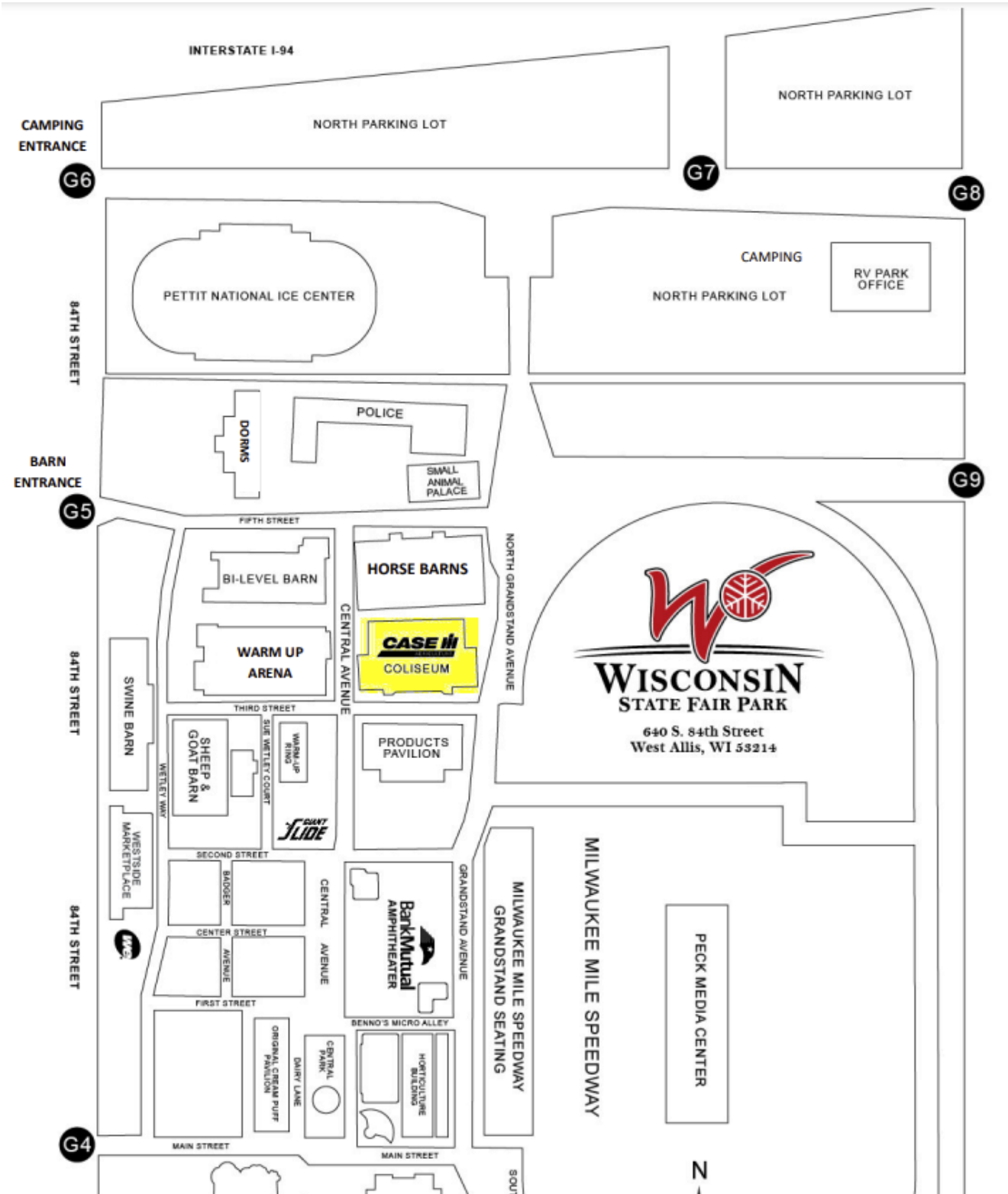

**REMINDER:** All streets within State Fair Park are city streets. There must be a clear passage for emergency vehicles AT ALL TIMES! Tickets will be issued if illegally park

## 2023 State 4-H Expo Trail Pattern

In Hand Trail will trot all designated lope/canter  
Refer to "Equestrian Guidelines" for trail rules!!

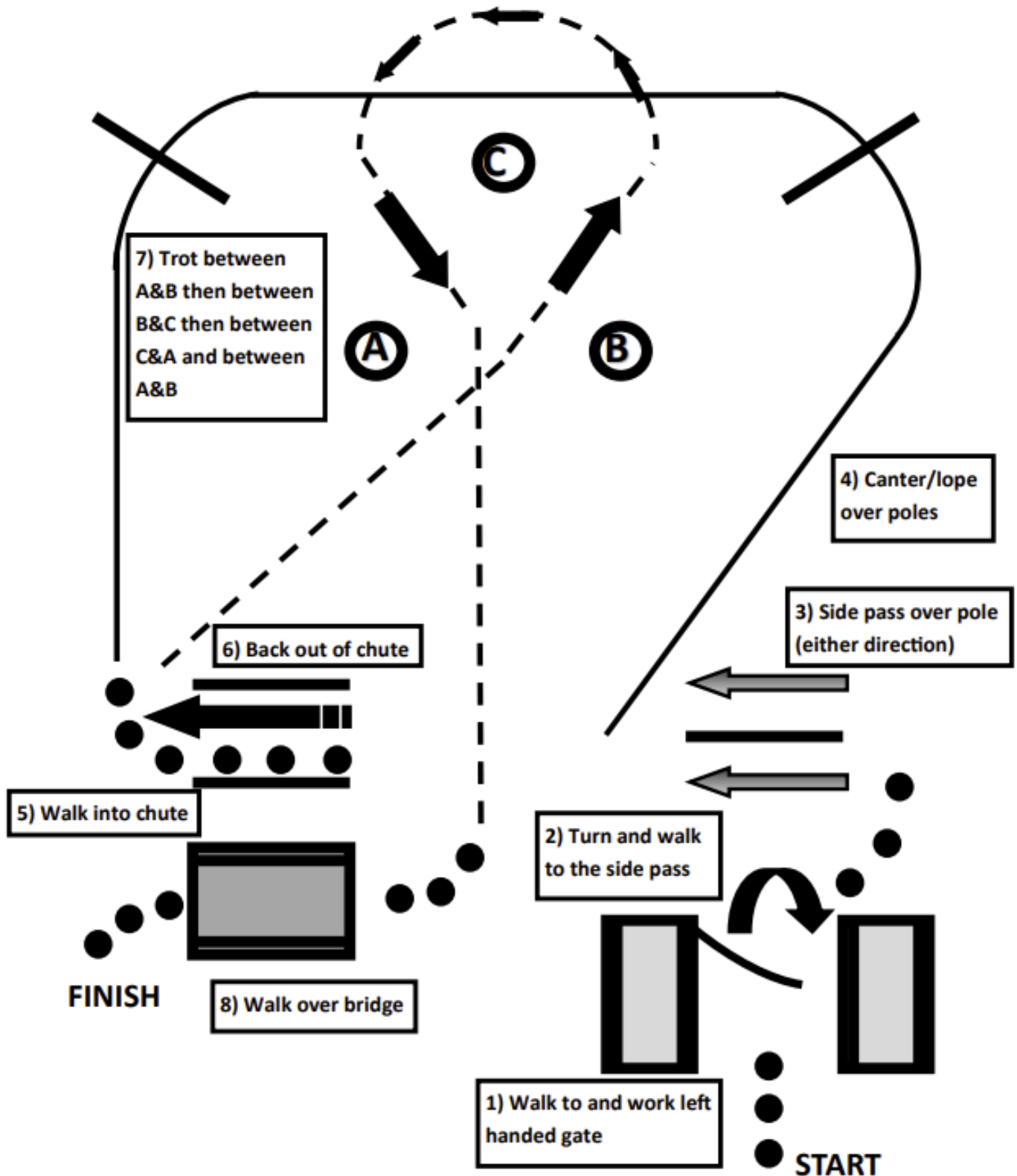

# **RV PARK INFORMATION**

## **For the 4-H Horse Shows**

**All RV's and tack/horse trailers with sleeping accommodations (if being used) MUST be parked At the RV Park or Overflow Areas in the north parking lot of the Wisconsin State Fair.**

Sites CANNOT be held without a deposit

Contact RV Park for Deposit or Cancellation policies.

Please call the RV Office at (414) 266-7035 to make reservations

(Let RV Park know if your unit is larger than 40' – truck and trailer)

---

## **DORM ROOM RESERVATIONS**

### **at WI STATE FAIR PARK TOMMY THOMPSON CENTER**

**Reservation deadline is September 7th**

Please use the link below for to make your reservations:

<https://wistatefair.com/wsfp/wisconsin-4h-horse-expo-room-reservation/>

Dorms and reservations are conducted through WI State Fair Park and Staff. Please make sure to read through all of their rules and reservation guidance.

Questions? If you have questions, contact dorm reservations at: 414-266-7300 or email: [dormreservations@wistatefair.com](mailto:dormreservations@wistatefair.com)

# WISCONSIN STATE 4-H HORSE ASSOCIATION VOLUNTEER FORM

**We need Youth and Adult help to make this expo a success.**

Last year our volunteers did a GREAT job filling in for all areas of the Expo! We are looking for help again this year in any/all of the following areas:

- OFFICE - General paperwork, information and directions.
- GATE - Check in entries, maintain order while exhibitors are entering and exiting gate. (16 & over please)
- SHAVINGS - Sell bales from truck. (Some lifting required.)
- PRACTICE RING - Monitor rules and ensure safe horsemanship. (16 & over please)
- EDUCATIONAL - Help hang exhibits, score test sheets, assist judges, assist during judging contest, etc..

We need help in the office Wednesday evening from noon - 10:00 pm, in all areas on Thursday, Friday and Saturday from 6:00 a.m. to 10:00 p.m., and on Sunday from 6:00 a.m. to 4:00 p.m. Most shifts will run two (2) hours.

Please sign up in the Coliseum office when you arrive at State Expo. Check in Expo Show Office ten (10) minutes before your shift to pick up badge and instructions. If problems arise please contact Show Office or Executive Secretary.